

PLAN SHOWING THE PROPOSED CONSTRUCTION OF A RESIDENTIAL BUILDING AT PLOT NO. 26A/1, KAVERI STREET, SALIGRAMAM, CHENNAI - 93. NEW T.S. NO. 126/16, T.S. NO. 134/3A/D, BLOCK NO. 37, OF SALIGRAMAM VILLAGE, OF DIVISION NO. 129, ZONE - VIII.

JOINERIES-

D	DOOR	3' 3" X 7' 0"
D1	DOOR	3' 0" X 7' 0"
D2	DOOR	2' 6" X 7' 0"
W	WINDOW	5' 0" X 4' 6"
V	VENTILATOR	3' 0" X 2' 0"
FW	FRENCH WINDOW	4' 0" X 6' 6"

AREA STATEMENT-

	SQ. FT.	SQ. MT.
PLOT EXTENT (as per sub-division)	3299.00	306.48
PLOT EXTENT (as per site)	3125.00	290.40
GROUND FLOOR	1074.85	99.85
FIRST FLOOR	1886.10	175.30
SECOND FLOOR	880.25	81.80
TOTAL AREA	3841.00	358.80
PLOT COVERAGE	60.35%	
F.S.1	1.22	
STILT FLOOR	740.00	68.75

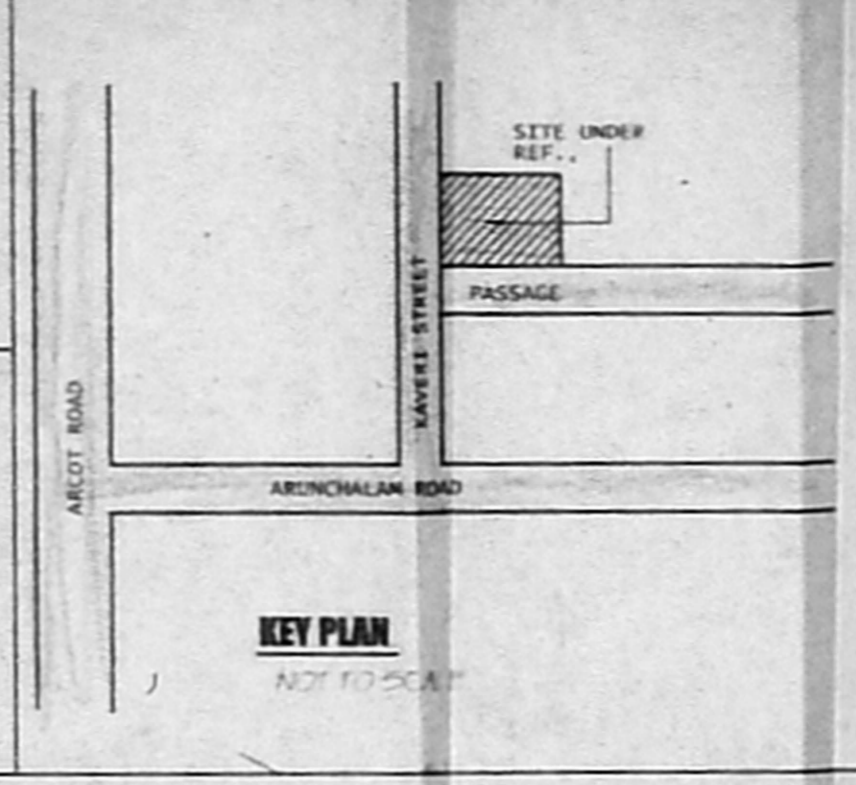
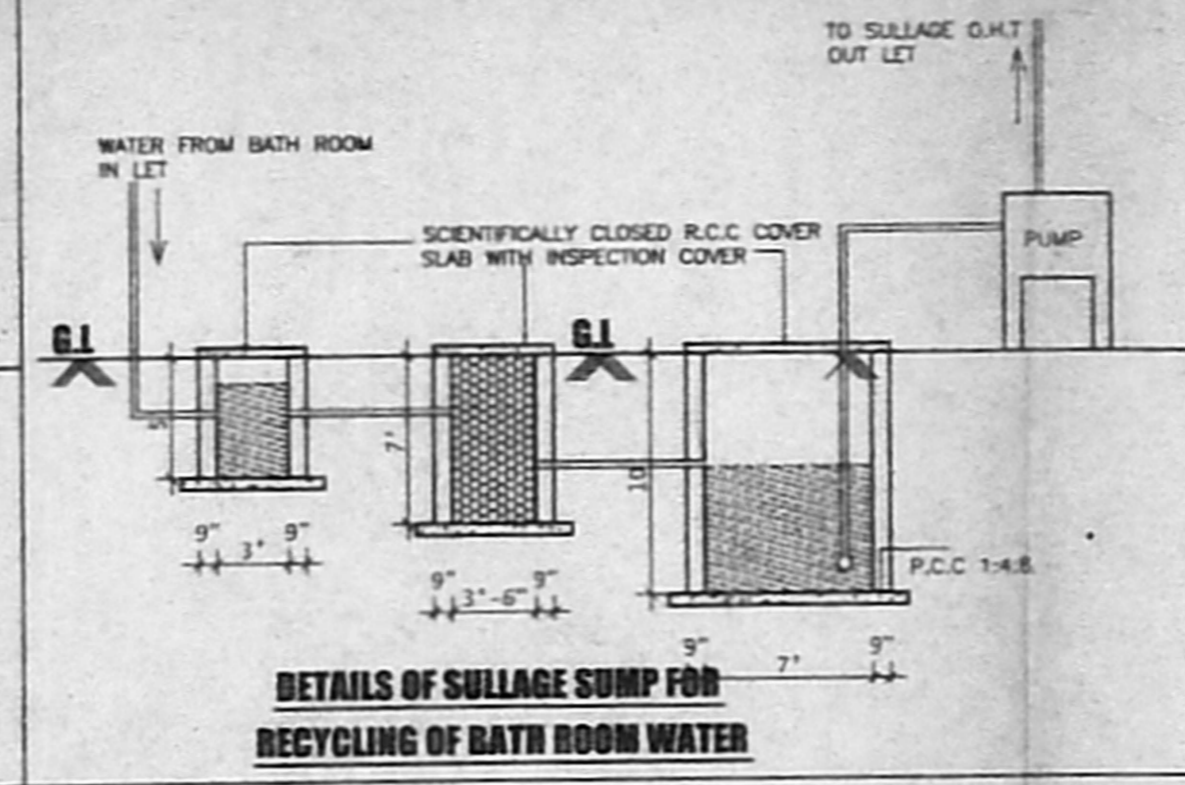
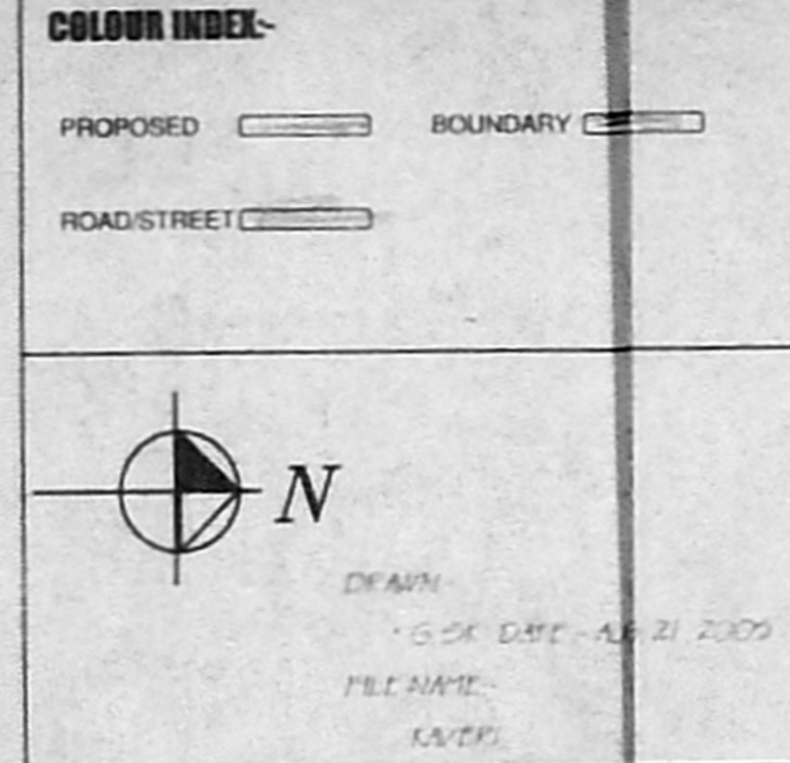

OWNER: *E. Yashwanth*

LICENSED SURVEYOR: *SEVARENGARAI, L.C.E.*
LICENSED ENGINEER, CL No. 207,
CORPORATION OF CHENNAI,
PANEL ENGINEER STATE BANK OF INDIA,
NEW No. 3, [OLD No. 2], NORTH USMAN ROAD,
T. NAGAR, CHENNAI-600 017.
PHONE: 8343138

Handwritten notes: *RP 1*, *87x61*, *21/9/09*

